

DREXEL UNIVERSITY ACADEMIC PROFILE

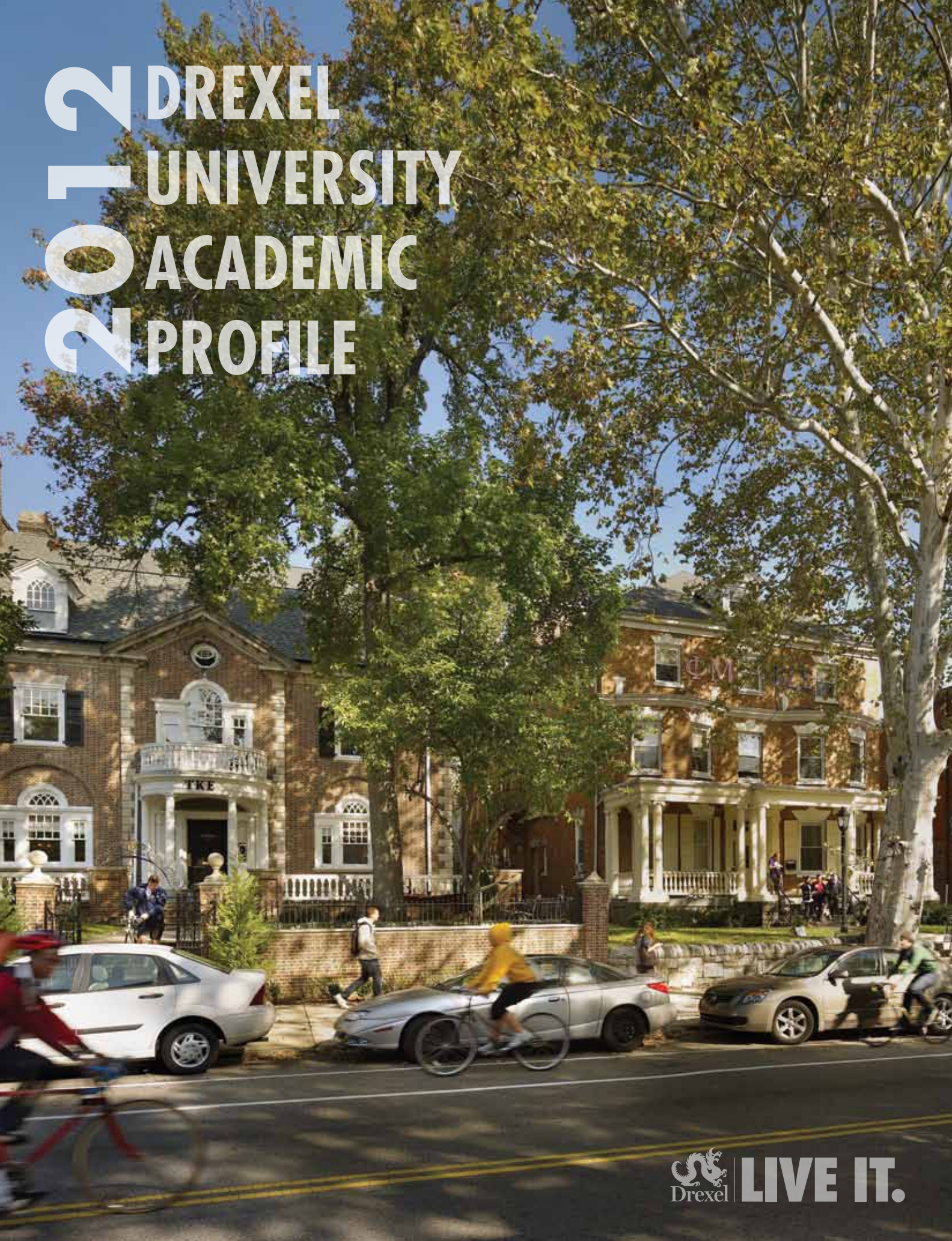

Drexel | **LIVE IT.**



Greetings from Drexel

There's more than one way to expand a university, and Drexel's Enrollment Management division proved it in 2012.

After more than a decade of rapid growth, Drexel made the strategic decision this year to cap its freshman class size at 2011 levels, allowing us to focus even more closely on academic quality. We are delighted with the results.

While enrolling a class of 3,000 first-year students, we increased the average GPA from 3.4 to 3.6, with average combined SAT scores increasing nearly 20 points. At the same time, we continued to increase geographic diversity, attracting a larger percentage of students from outside the Mid-Atlantic region, including internationally. Even with all of these changes, our total enrollment of more than 26,000 students across all levels, on-campus and online, is the largest in University history.

What this demonstrates is that — through our rise in national and world rankings and our mission of applied education with an emphasis on undergraduate research and community engagement — Drexel has gone global.

In the near future, the University will cultivate this trend, by continuing to recruit new students from outside of our primary market, by encouraging current students to participate in international co-ops, by providing the means for research across disciplines and boundaries, and by continuing to engage with the world beyond academia, as we did in sponsoring the Philadelphia Orchestra's 2012 China residency.

Meanwhile, at home we're investing in public safety, retail development, community enrichment, health and wellness, and more. And because another growth spurt is both inevitable and desirable, we're making improvements, both in academic offerings and infrastructure. Our historic agreement with what is now known as the Academy of Natural Sciences of Drexel University has led to a groundbreaking new department — the Department of Biodiversity, Earth, and Environmental Sciences (BEES) — that integrates theory and practice, combining traditional coursework with field experiences that begin even before the first class term. As for the physical campus, the Westphal College of Media Art & Design's new home, the URBN Center, opens this fall; we just hosted a topping off ceremony for the 12-story, 177,500 square-foot LeBow College of Business facility set to open fall 2013; and work continues on the Chestnut Street development, which will include retail outlets, neighborhood restaurants, and housing for more than 800 students.

But all of this barely scratches the surface. Read on and learn more about what makes us the most exciting university in the nation.

Joan T. McDonald
Senior Vice President, Enrollment Management

University Fast Facts

At Drexel, a truly rewarding experience means being actively engaged in the campus community. Here are a few statistics related to the undergraduate experience, in and out of the classroom.

Number of Full-Time Undergraduate Students.....	12,750
Average Class Size	18
Freshman to Sophomore Retention Rate	85%
Students in the Pennoni Honors College	2,294
Student Life Organizations on Drexel's Campus	339

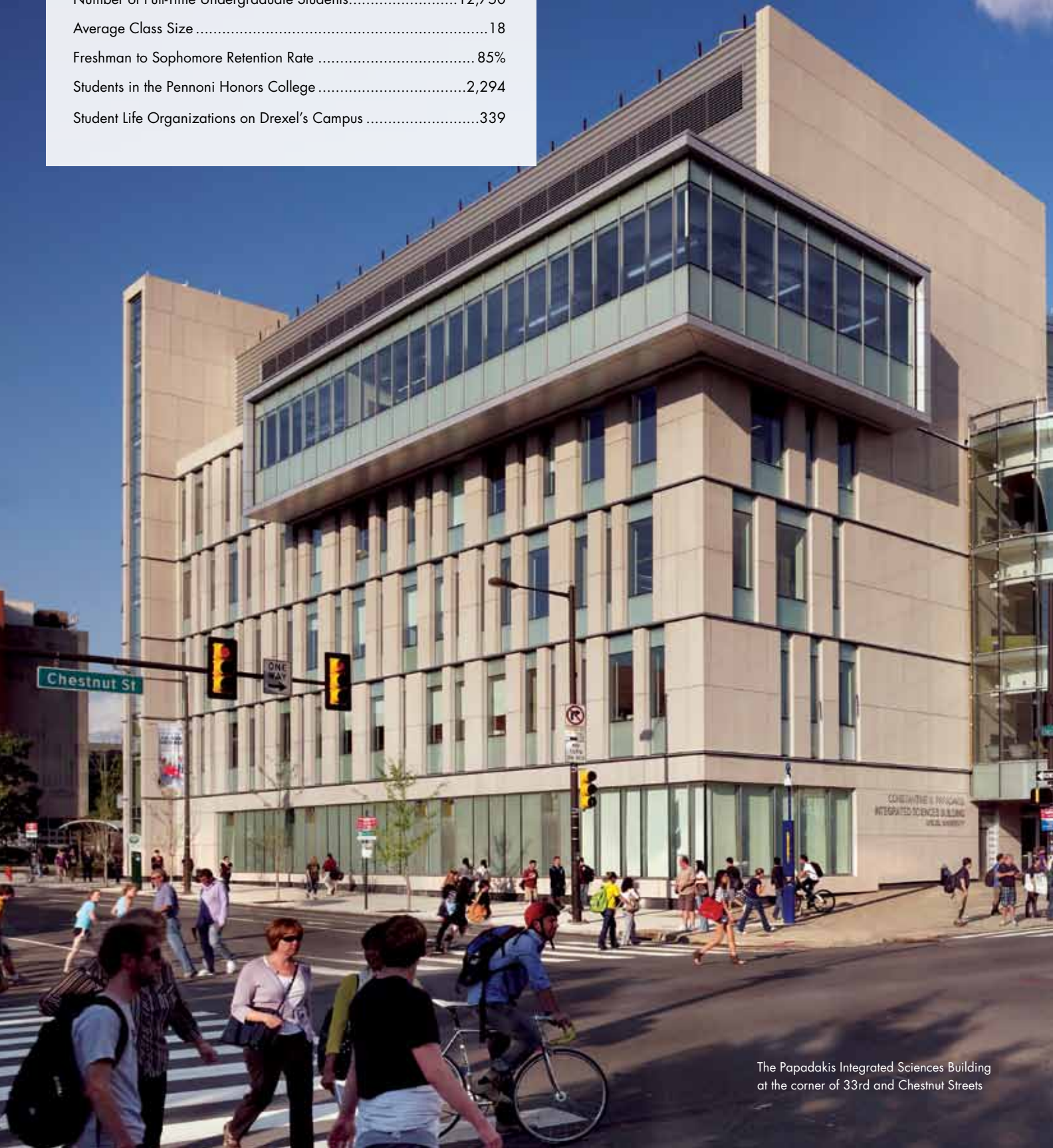

The Papadakis Integrated Sciences Building
at the corner of 33rd and Chestnut Streets

Geographic Distribution of Full-Time Freshman Students

We believe diversity — geographic and cultural — is essential. Drexel freshmen come from 41 U.S. states and 74 foreign countries. International students comprise 15 percent of our freshman population.

**Seventeen of our domestic freshmen currently live outside of the United States.*

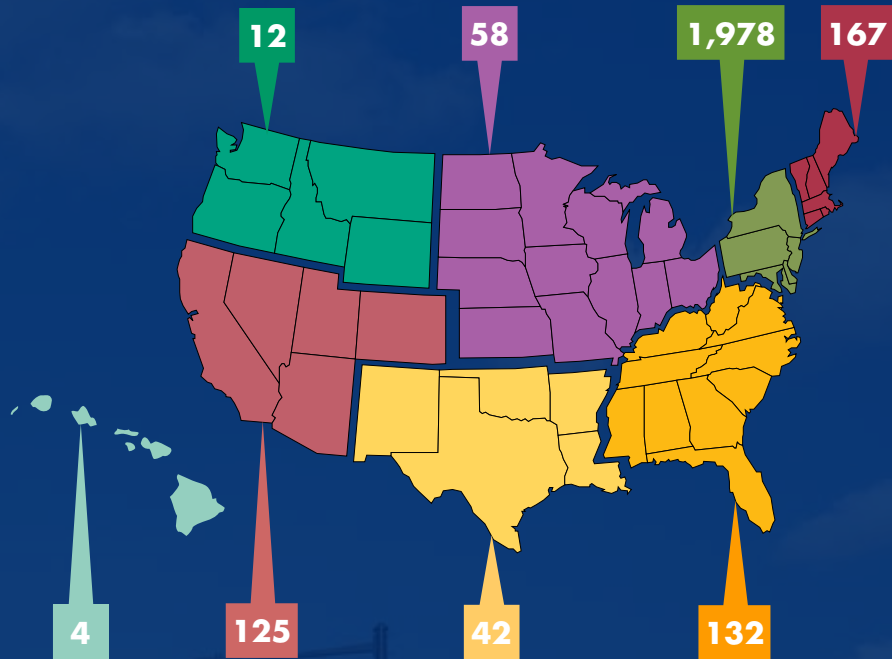

Number of domestic freshmen by region*

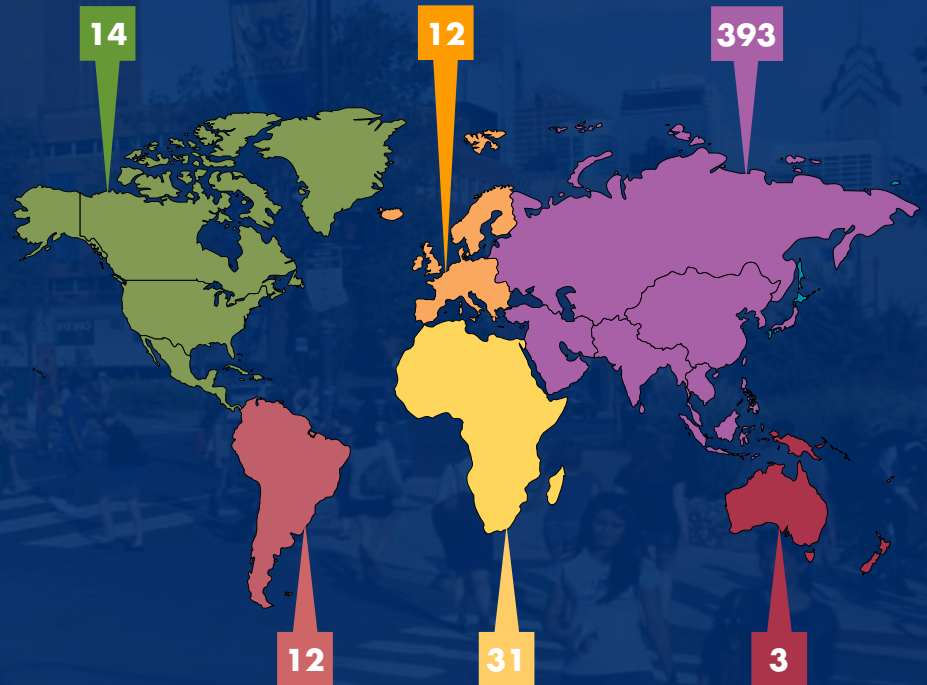

Number of international freshmen by continent



Tuition and Fees for 2012-2013

	One Co-op Option (4 Years)*	Three Co-op Option (5 Years)
Tuition	\$41,500	\$33,800
Fees	\$2,300	\$2,300
Housing	\$5,625-\$9,570	\$5,625-\$9,570
Meal Plan	\$5,490-\$5,745	\$5,490-\$5,745

**This track is also available to students who wish to pursue a degree without a co-op experience.*

A Drexel student researcher at the Barnegat Bay Field Station in New Jersey

Financing a Drexel Education

Drexel is committed to making a quality education affordable. The University offers students a variety of ways to finance their education. These awards are based on academic performance, athletic achievement, extracurricular involvement, or financial need.

Scholarships

- Drexel's National Merit Scholarship – full tuition and fees
- Drexel Liberty Scholarship – full tuition and fees
- A.J. Drexel Scholarship – partial tuition
- Dragon Family Scholarship – \$3,000 per year
- Drexel Legacy Scholarship – \$3,000 per year
- Dragon Alumni Scholarship – \$1,000 per year

- Athletic Scholarship – \$1,000 to full athletic awards
- Performing Arts Scholarship – up to \$2,000 per year
- ROTC Scholarship – partial to full tuition
- Yellow Ribbon Program for veterans

Grants

- Drexel Early FAFSA Grant – \$1,000
- Federal Pell Grant – up to \$5,550
- Pennsylvania Grant Program – up to \$4,348

Loans

- Federal Perkins Loan
- Federal Direct Stafford Student Loan
- Federal Direct Parent Plus Loan

Financial Assistance

- Percentage of the class applying for financial assistance: 76
- Average financial assistance package offered: \$23,000
- Total financial aid funds managed in the most recent academic year: \$606 million

Drexel Co-op: Knowledge at Work

Our prestigious, nationally ranked co-op program continues to equip students with the skills necessary to succeed in the professional world. Take a look at last year's statistics:

- Number of states with active co-op employers: 35
- Number of global co-op locations: 35

Average Gross Six-Month Co-op Salaries*

College of Arts and Sciences.....	\$14,262	The <i>iSchool</i> at Drexel, College of Information Science and Technology.....	\$17,608
School of Biomedical Engineering, Science, and Health Systems.....	\$16,510	Westphal College of Media Arts & Design.....	\$12,624
LeBow College of Business.....	\$15,800	College of Nursing and Health Professions	\$13,154
School of Education	\$11,137	Goodwin College of Professional Studies	\$14,522
College of Engineering	\$17,401		

**Does not include volunteer co-op positions or co-op students receiving stipends.*

A Year of Highlights: 2012 in Review

Building Community

Our neighborhood has always been a priority.

- In the past several months, Drexel has announced major new education and health initiatives for residents of all ages throughout our hometown, through partnerships with, and support from, organizations including Independence Blue Cross and the City of Philadelphia.
- The Drexel Autism Institute is developing a mobile clinic in collaboration with students from the Westphal College of Media Arts & Design. It will be used by clinical assessment teams making site visits to evaluate children taking part in research studies and participating in model programs.
- The Academy of Natural Sciences of Drexel University affiliation continues to create greater access to the academy's facilities and collections and has resulted in a groundbreaking academic unit — The Department of Biodiversity, Earth, and Environmental Science (BEES) — which provides research opportunities throughout the region and around the world.

Expanding Our Network

We're preparing the University and its students for a global future.

- In June, Drexel officially opened the Drexel-SARI (Shanghai Advanced Research Institute) Center in China. The center will be a home for Drexel's research collaborations and educational partnerships with SARI and other institutes of the Chinese Academy of Sciences, offering Drexel faculty and student researchers insight into the latest technology and innovation in China.
- Drexel was also the sponsoring education partner of the Philadelphia Orchestra's 2012 Residency and Tour of China. As part of this, we sent a delegation from Drexel (including Assistant Vice President for Admissions Erin M. Finn) to host a free rehearsal performance of the orchestra.
- Drexel students have been taking advantage of our Fellowships Office to gain international experience. This year, students received a Fulbright, a Lindau award (to attend the annual meeting of the Nobel Laureates), and the Udall Scholarship, a prestigious award for students committed to environmental careers, among others.

Under Construction

We in Enrollment Management can watch Drexel changing from the windows of our offices.

- The 144,000-square-foot URBN Center will be completed this fall. The building, a complete renovation by Meyer, Scherer and Rockcastle of Robert Venturi's iconic "decorated shed" at 35th and Market, will be a state-of-the-art home for the Westphal College of Media Arts & Design.
- With the demolition of Matheson Hall complete, construction is well underway on a 12-story, 175,000-square-foot building named in honor of Bennet S. LeBow, whose \$45 million gift is the largest in Drexel history. It will contain a 300-seat auditorium, a 100-seat lecture hall, class- and seminar-rooms, offices, and conference space.
- The \$97.6 million Chestnut Square development broke ground this year and is already rising up around us. It will be composed of three buildings ranging from eight to 19 stories and will include retail outlets, neighborhood restaurants, and student apartments with both shared and private accommodation options.

Incoming Class of 2012

Introducing Our New Class

This year our new class was selected from a talented pool of 41,126 applicants. We are proud to introduce the newest members of the Drexel community.

2012 Incoming Class

Applications 41,126

New Class Size 3,000

Secondary Schools Represented
in Freshman Class 1,441

Rank in High School Class

Top 10% 33%

Top 15% 46%

Top 25% 64%

Matriculants from All Secondary Schools

Average GPA
(unweighted, on a 4.0 scale) 3.6

Average SAT Math scores
(25th–75th percentiles) 580–690

Average SAT Critical Reading scores
(25th–75th percentiles) 540–640

Average SAT Writing scores
(25th–75th percentiles) 530–640

A.J. Drexel Scholars

Named for the University's founder, A.J. Drexel Scholarships are awarded to the top 25 percent of entering freshmen.

Average GPA
(unweighted, on a 4.0 scale) 4.0

Average SAT Math scores
(25th–75th percentiles) 640–720

Average SAT Critical Reading
scores (25th–75th percentiles) 590–670

Average SAT Writing scores
(25th–75th percentiles) 590–670

Diversity

American Indian or Alaska Native 0%

Asian 16%

Black or African American 4%

Hispanic 5%

International 15%

Native Hawaiian or Other
Pacific Islander 2%

Two or More Races 2%

White 56%

Incoming Class of 2012 by College/School

College of Arts and Sciences 693

School of Biomedical Engineering,
Science, and Health Systems 197

LeBow College of Business 522

School of Education 23

College of Engineering 857

The iSchool at Drexel,
College of Information
Science and Technology 29

Antoinette Westphal
College of Media Arts & Design 390

College of Nursing
and Health Professions 201

Goodwin College of
Professional Studies 88

The Admission Process

Required Materials

- Application
 - Online: www.drexel.edu/ugapp
 - or the Common Application (www.commonapp.org)
- Official High School Transcript
- Score Reports from SAT or ACT
- Two Letters of Recommendation
- Personal Essay

What We Look For

- Strong and consistent academic background
- Challenging class selection, including Honors, AP, or IB coursework
- Commitment to leadership in high school or surrounding community through participation in extracurricular activities

Admission Deadlines

November 15

- Early Decision admission applications due
- Applications due for the BA/BS/MD Accelerated Degree program

January 15

- Regular decision freshman applications due
- Enrollment form and tuition deposit due for students accepted Early Decision

February 15

- Free Application for Federal Student Aid (FAFSA) due (Applicants who submit by this date are eligible for the \$1,000 Drexel FAFSA Award.)

May 1

- National Candidates' Reply Date for students accepted regular decision

A Special Note for Guidance Counselors

In an effort to ensure a positive application process for prospective students, Enrollment Management offers these resources for secondary school counselors.

Guidance Counselor Portal

The Admissions Update for Guidance Counselors is a website that will allow high school guidance counselors to quickly and easily check the application status of their students who have applied to Drexel.

Register for access at

www.drexel.edu/undergrad/admissionsupdate.

ConnectEDU

Drexel University has partnered with ConnectEDU to link students, counselors, and admission representatives through Connect!, the nation's only integrated web-based student transition tool. Connect! brings students and administrators together during educational and career transitions. Through Connect!, students are networked into a community of users focused on providing information and guidance in an effort to streamline the admission process. Here are some of the features Connect! offers:

- Seamless communication between students, parents, guidance counselors, and representatives from Admissions
- The ability for students to map out curriculum, college, and career paths
- Up-to-date tracking of admission status
- A platform for electronic submission of admission materials

To learn more about ConnectEDU visit www.connectedu.net.



facebook.com/drexeladmission



twitter.com/drexeladmission



youtube.com/drexeluniv



3141 Chestnut Street • Philadelphia, PA 19104